

Scale[®] / 4 from **Panelfold[®]**

LAMINATED SINGLE PANEL FOLDING DOOR

INSTALLATION INSTRUCTIONS - READ CAREFULLY

Thank you for choosing a Panelfold[®] door. We know you will be delighted with its distinctive features and quality, and will appreciate the valuable floor space it returns to you... space that would have been wasted by a swinging, bi-fold, or sliding door. Panelfold[®] doors are designed to help you enjoy all of your living space whether you use them at closets or doorways, to hide utility areas, or as room dividers.

Before installing your Panelfold[®] door, please read these instructions. A little extra care now will reward you with a professional appearance and smooth operation for many years. Your new wood folding door is like a fine piece of furniture. We recommend you give it similar care.

Tools Required: Electric Drill, Phillips Head Screwdriver (bit), Hacksaw,
Flat Blade Screwdriver.

SECTION 1

Installation of Single Doors

Door track is pre-punched on 8" (203.2mm)
centers for heights thru 8'-1" (5486mm) ,

Panhead sheet metal screws are furnished:

No.10 x 1¼"

Should other screws or fasteners be used,
the head size must not be larger than those
furnished.



No.10 x 1¼"
Pan Head Screw

STEP 1

- A. Mark and pre-drill header to match holes in track. Extreme care shall be taken to prevent shavings or any other foreign material getting into track.

DO NOT DRILL THRU TRACK

If more than one track section is supplied,
care must be taken where the two track ends
meet to secure them to the header in precise
alignment to assure smooth, trouble-free
travel of the carriers.



STEP 1(Cont'd)

- B. REMOVE TOP ONLY from door carton. (Main carton must not be removed until door is suspended in track). Carefully stand door on bottom with top wheels directly beneath track location.
- C. Slide track onto wheels and begin installing track screws at far end. Secure enough screws to support door in a partially extended position. Remove remaining carton and inner packing. Very carefully move door to the secured portion of the track. Install remaining screws in track.

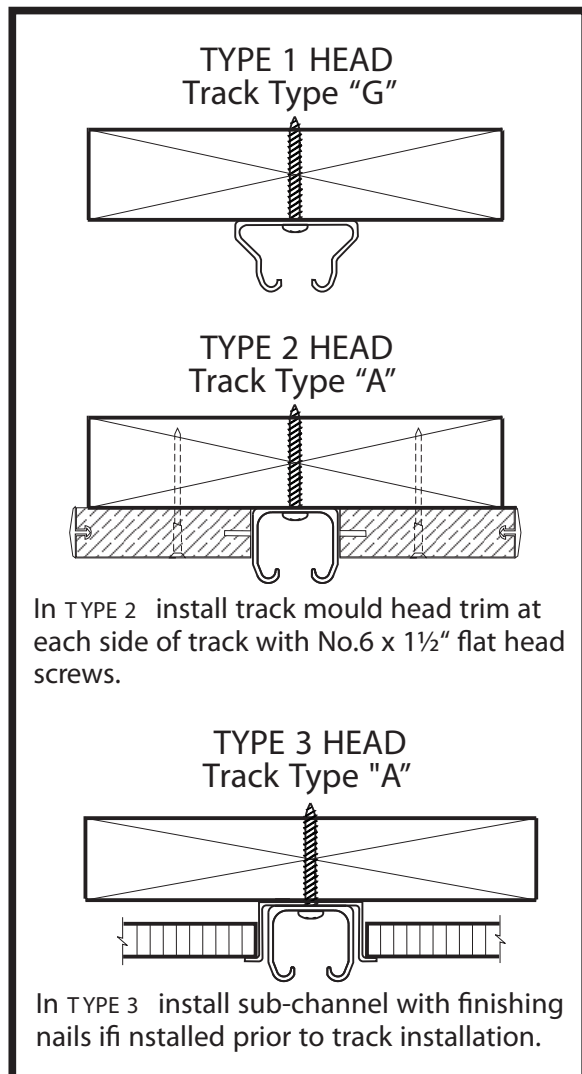

STEP 2. Fixed Jamb Attachment

- A. Install the Jamb Attaching Panel with the No.6 X 1½" flat head screws provided.

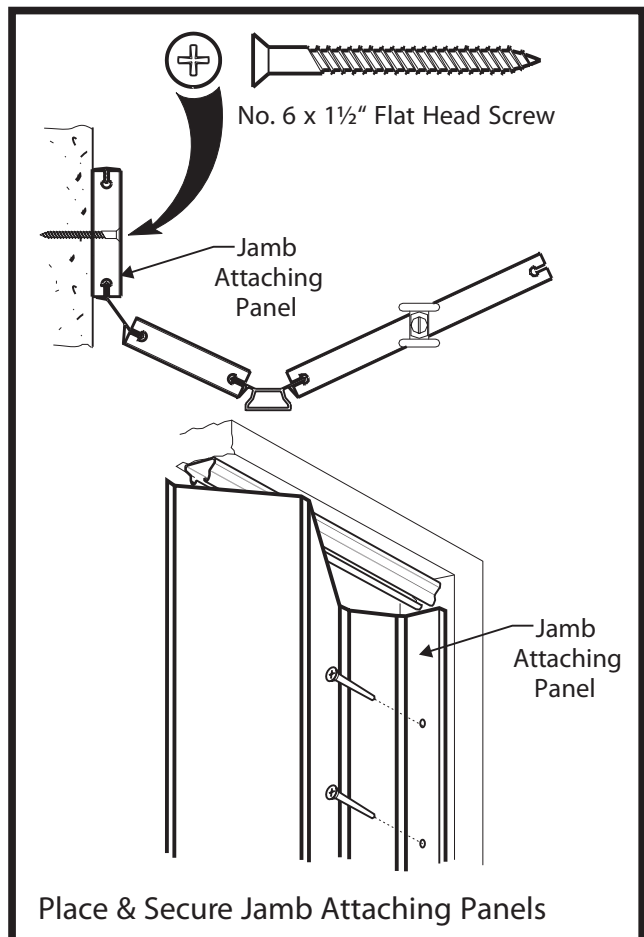
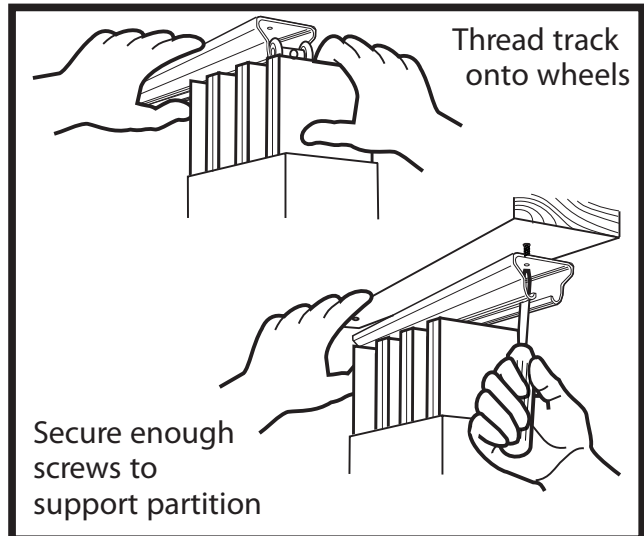
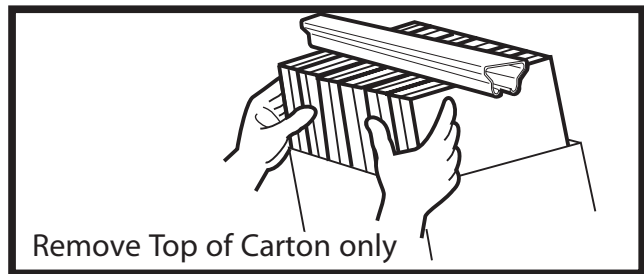

STEP 2 (Cont'd)

- B. If your door has a latch at one end only follow this step; if it has latches at both ends skip to STEP 3.
With door in stacked position, hanging relatively plumb, mark jamb at outside edge of jamb attaching panel for No. 6 X 1½" wood screws. Open door enough to mark pilot holes locations. Drill pilot holes and install screws.

STEP 3

- A. Place jamb mould (for Single-Fixed Jamb or Double-End Post Partitions) in a plumb position directly under the track. Insert notched end of jamb mould into track and install top No. 6 x 1½" wood screw. Move door to engage latch. With endpost and jamb mould aligned, mark jamb at edge of jamb mould. Open door and secure with remaining flat head screws supplied.
Note: Should it become necessary to shorten the jamb mould, cut off bottom only

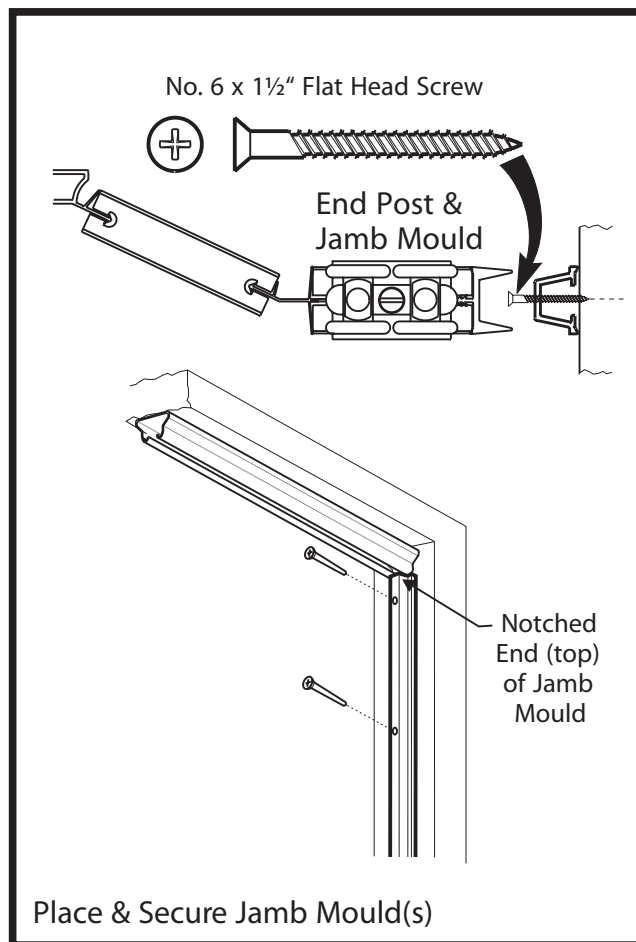

SECTION 2

Installation of Double Doors

- A. Measure opening width and divide the result by two (2). Cut each track section 1/8" (3.175mm) shorter than measurement. This leaves room for screw "stop" when track is installed.
- B. Follow STEP 1A and 1B except placing both doors opposing each other directly under one half of opening,
- C. Thread first half of track onto wheels of both doors and begin installing track screws as in STEP 1C.
After securing all track screws in one half of track, install second half of track.
Move second partition to second half of track. Set a screw at track center joint and leave projecting 1/2" (12.7mm) to "stop" wheels of either door from traveling past the joint.
- D. Follow partition installation STEP 2

Insert Track Screw half way to provide a "stop" at the center of opening for Double Doors

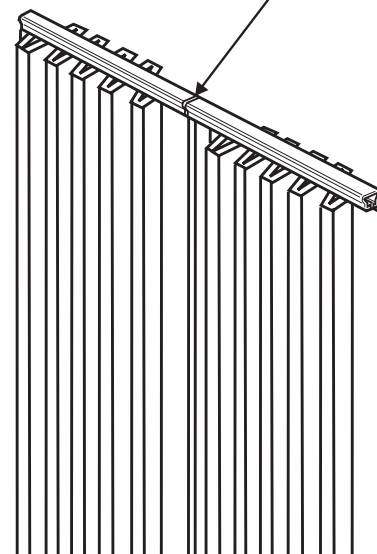

SECTION 3

Adjustments and Alignment

- A. If end post hangs away from jamb at bottom, remove screws from jamb-attaching panel. Loosen track screws and shim track at jamb panel end until end post hangs plumb. Secure jamb-attaching panel in new position.
- B. If end post hangs away from jamb at top, shim track at end post edge. Relocate hatch strike if necessary.
- C. If end posts of opening doors do not meet properly, shim track as described above and/or relocate jamb-attaching panel.

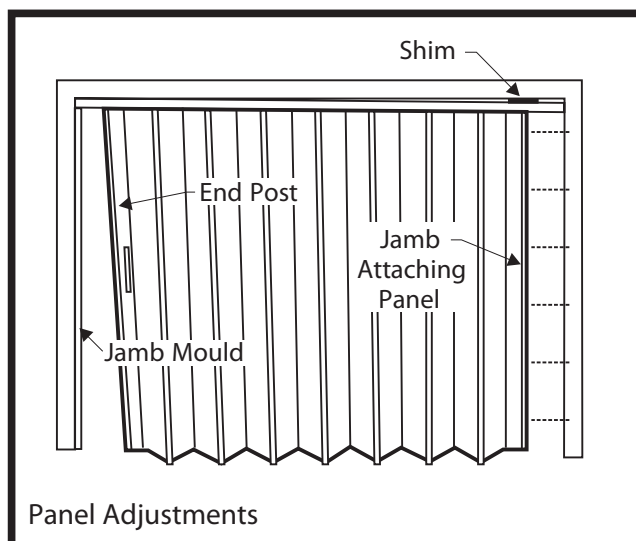

SECTION 4

Door Trimming

Lay stacked door across a sturdy support. Carefully cut door off at bottom to required dimension, using a fine tooth saw.

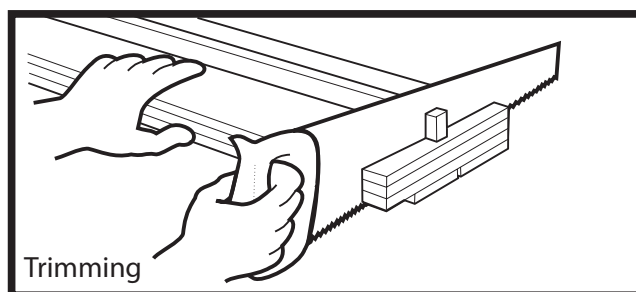

SECTION 5

Care

Your Panelfold® door will retain its beauty for many years with a minimum of care. You may clean it with warm water and mild soap. Sponge surface and wipe dry with soft, clean cloth. A good quality furniture polish may be applied.

DOOR TRACK MUST
BE THOROUGHLY LUBRICATED
WITH LUBRIPLATE OR SIMILAR
PRODUCT FOR EASY AND
TROUBLE-FREE OPERATION

Unfinished Doors must be finished immediately to avoid warpage.

Use any good quality hand-applied finishing material, such as liquid stain wax. Vinyl connector hinges need no further finish.

CAUTION: NEVER STORE ON END
Keep in carton until ready to install

LIMITED WARRANTY: Your Panelfold® door is covered by one (1) year limited warranty. Ask us for details.

FIRST CHOICE ACCORDION DOORS • Phone: 877-723-0209 • FAX: 503-723-0503
Internet: www.accordion-door.com e-mail: Sales@Accordion-Door.com